

Mini Bus
 Overall Length 6.330m
 Overall Width 2.192m
 Overall Body Height 2.601m
 Min Body Ground Clearance 0.374m
 Track Width 2.192m
 Lock to lock time 4.00s
 Kerb to Kerb Turning Radius 6.450m

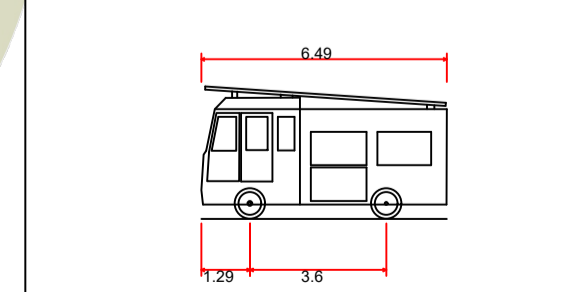

Dennis Rapier Fire Tender
 Overall Length 6.490m
 Overall Width 2.300m
 Overall Body Height 3.498m
 Min Body Ground Clearance 0.363m
 Track Width 2.300m
 Lock to lock time 5.00s
 Kerb to Kerb Turning Radius 6.095m

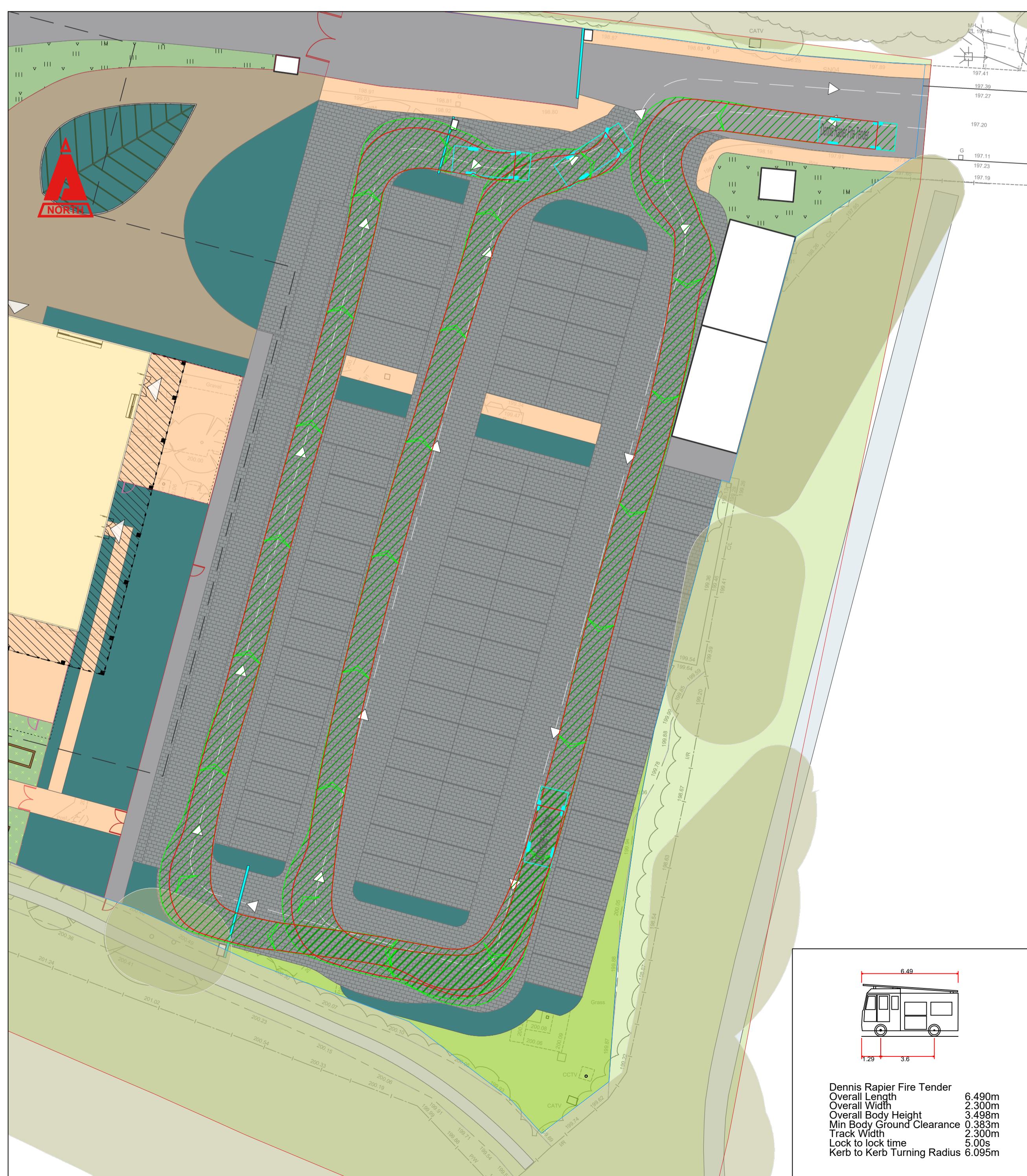
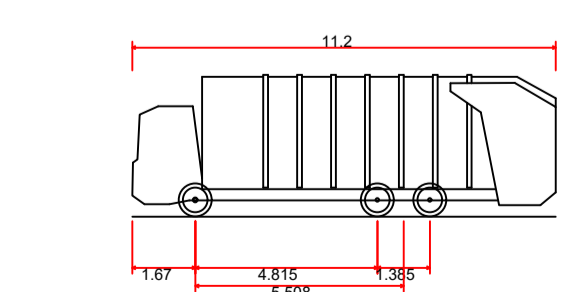
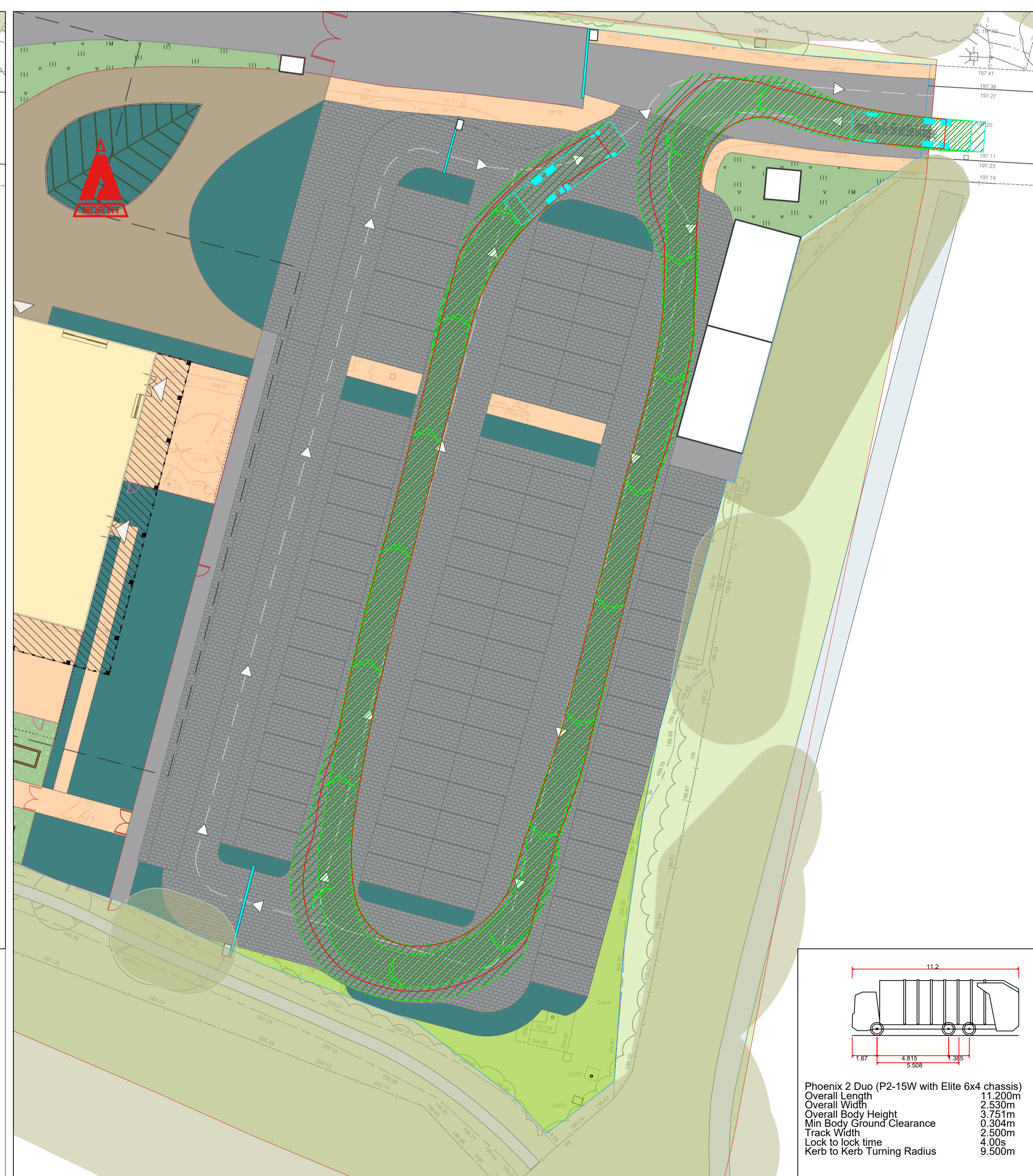

Phoenix 2 Duo (P2-15W with Elite 6x4 chassis)
 Overall Length 11.200m
 Overall Width 2.530m
 Overall Body Height 3.751m
 Min Body Ground Clearance 0.304m
 Track Width 2.500m
 Lock to lock time 4.00s
 Kerb to Kerb Turning Radius 9.500m

THIS DRAWING IS COPYRIGHT © CAMBRIA CONSULTING LTD.
 DO NOT SCALE FROM THIS DRAWING.
 CONTRACTORS MUST CHECK ALL DIMENSIONS ON SITE. ONLY FIGURED DIMENSIONS ARE TO BE WORKED FROM. DISCREPANCIES MUST BE REPORTED IMMEDIATELY TO CAMBRIA CONSULTING LIMITED BEFORE PROCEEDING.
 THE CONTRACTOR IS TO REFER TO THE SPECIFICATION, FULL SCHEDULE OF RESIDUAL RISKS IN THE CONTRACT DOCUMENTATION AND ALSO TO INFORMATION FROM OTHER DESIGNERS, IN PARTICULAR THE M&E CONSULTANT REGARDING EXISTING LIVE SERVICES.
 THIS SYMBOL IS USED TO HIGHLIGHT INSTANCES OF RISK WITHIN THE CONSTRUCTION PROCESS.
 ALWAYS CHECK FOR LATER REVISIONS OF THIS DRAWING.

KEY
 CHASSIS OUTLINE
 OVERHANG OUTLINE

P05	UPDATED SITE PLAN	JD	LM	LM
				13.09.2024
P04	UPDATED MINIBUS TRACKING	JD	LM	LM
				11.09.2024
P03	UPDATED SITE PLAN	JD	LM	LM
				03.09.2024
P02	UPDATED SITE PLAN	GJ	LM	LM
				29.08.2024
P01	FOR INFORMATION	GJ	LM	LM
				19.07.2024
Rev.	Description	By	Chk	App

Client:
MORGAN SINDALL

Project:
CLYDACH & VALE ALN SCHOOL
 CC2671

Drawing Title:
VEHICLE TRACKING REFUSE, FIRE VEHICLES & MINIBUS

Drawing No.
 26CC05 CAM XX XX SK C 0003

Status:	SS PRELIMINARY	Scale @A1:	AS SHOWN	Rev.	P05
---------	----------------	------------	----------	------	-----

CAMBRIA
 Constructive Thinking
 Civil & Structural Engineers T 029 2009 3333
 Cambria House E admin@cambria.co.uk
 16 Plas St. Pol de Leon W www.cambria.co.uk
 Penarth Marina @cambriauk
 Cardiff, CF64 1TR uk.linkedin.com/in/cambriauk