

| Luminaire Schedule | | | | | |
|--------------------|-------|-------------------------|-------------------|--------------------------|-----------------------|
| Qty | Label | Arrangement | Total Lamp Lumens | Description | Tag |
| 8 | A | SINGLE POST TOP | 3599 | IP 12L70 - 730 - EWS | 6M SINGLE COLUMN MTND |
| 3 | AT | TWIN SIDE ENTRY BRACKET | 3599 | 2 x IP 12L70 - 730 - EWS | 6M TWIN COLUMN MTND |
| 27 | C | BLG MTND | 1815 | PIAZZA II 1690 - 830 | 2.5M BLG MTND |
| 20 | D | BOLLARD MTND | 937 | CN B 8L35 - 830 - RSC | 1M BOLLARD |
| 9 | B | SINGLE POST TOP | 3599 | IP 12L70 - 730 - EWS | 4M SINGLE COLUMN MTND |

| Calculation Summary | | | | | |
|----------------------------------|-------|-------|------|-----|---------|
| Label | Units | Avg | Max | Min | Min/Avg |
| BLG PERIMETER | Lux | 17.09 | 30.1 | 4.6 | 0.27 |
| BLUE PATH - WEST PATHWAY EXIT | Lux | 34.37 | 64.2 | 9.8 | 0.29 |
| RED ROUTE - DROP OFF / PLAY AREA | Lux | 10.93 | 21.0 | 3.5 | 0.32 |
| SPILL | Lux | 1.82 | 69.1 | 0.0 | 0.00 |
| CARPARK | Lux | 13.08 | 37.1 | 3.3 | 0.25 |
| ENTRANCE PLAZA | Lux | 21.15 | 69.1 | 3.5 | 0.17 |
| HABITAT AREA | Lux | 0.35 | 1.5 | 0.1 | 0.29 |

| UWLR Area Summary | |
|-------------------|------|
| Label | UWLR |
| UWLR | <1% |

6M COLUMNS X 11
TWIN SIDE ENTRY BRACKET FOR 6M COL + ISARO PRO X 3
4M COLUMNS X 9
TOTAL OF 23 X ISARO PRO LANTERNS

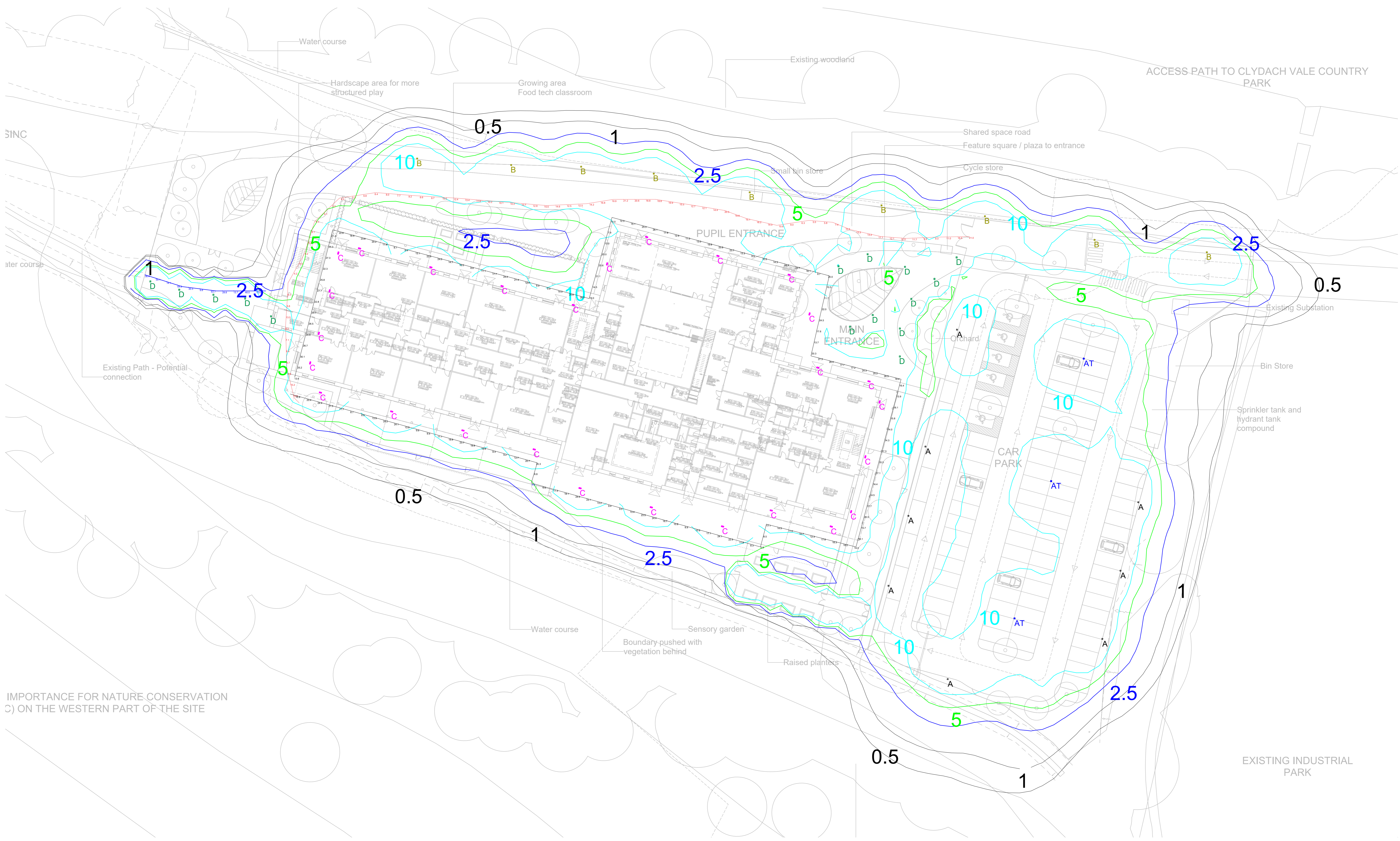

| Rev | Desc | Drawn | Checked | Date |
|-----|---------------|-------|---------|------------|
| P01 | STAGE 3 ISSUE | JP | KS | 27.09.2024 |

STAGE 3

TROUP BYWATERS + ANDERS
Bringing Buildings to Life

3 Park Place
Cardiff CF10 3DP
t: +44 (0)2920 003760
e: cardiff@troupa.com
w: www.troupa.com

Project: CLYDACH VALE ALN

Title: ELECTRICAL SERVICES EXTERNAL LUX PLOT

Client: RHONDDA CYNON TAF COUNTY BOROUGH COUNCIL
Architect: ATKINS REALIS

| Project No. | Drawn By | Date | Checked | Scale |
|-------------|----------|------------|---------|-------|
| WA0341 | RN | 11.09.2024 | KS | 1:250 |

Acad Model: 63 - External Lux Plot
Drawing No: 26CC05-TBA-55-XX-D-E-6318
Revision: P01