

**LEGEND**

Site Boundary

**SOFT LANDSCAPE**  
Refer to Soft Landscape Plan for details, dwg no. GSRB-STL-XX-XX-DR-L-9020

- Existing trees to be retained
- Proposed trees
- Existing Planting retained
- Proposed hedge planting
- Proposed ornamental shrub and herbaceous planting
- Proposed sensory planting
- Proposed rain garden / SuDS
- Grass
- Wildflower and species rich grass mix

**HARD LANDSCAPE**  
Refer to Hard Landscape Plan for details, dwg no. GSRB-STL-XX-XX-DR-L-09160

- Proposed asphalt surface to pedestrian areas  
Heavy duty build-ups will be required to servicing, maintenance and emergency access zone. Refer to Engineers plans for details
- Proposed asphalt surface to vehicular areas
- Proposed resin bound paving
- Proposed paving
- Proposed reinforced grass for maintenance access
- Proposed concrete slab to service area
- Proposed wetpour
- 2G sports pitch

**FURNITURE**  
Refer to Furniture Plan for details, dwg no. GSRB-STL-XX-XX-DR-L-????

- Benches
- Curved benches
- Tables and benches
- Canopy
- Outdoor gym equipment
- Cafe style tables and seating
- Sheffield cycle stands
- Knee rail

**FENCING**  
Refer to Landscape Hard Layout Plan for details, dwg no. GSRB-STL-XX-XX-DR-L-09180

- Existing Boundary Fence (to be retained)  
Repairs and making good as required.
- Proposed Fencing

**ECOLOGICAL ENHANCEMENTS**

- Bird box (mounted on existing trees)
- Bat box (mounted on existing trees)
- Log piles
- Hibernaculum
- Bee bank (bare earth)

**NOTE:**

- For levels and drainage information refer to engineers plans and details.
- All roof rain water run-off to discharge via green roof system or rain gardens.
- All other landscaping borders are purely ornamental with no dual drainage function.

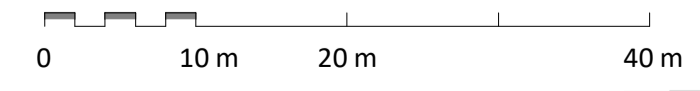
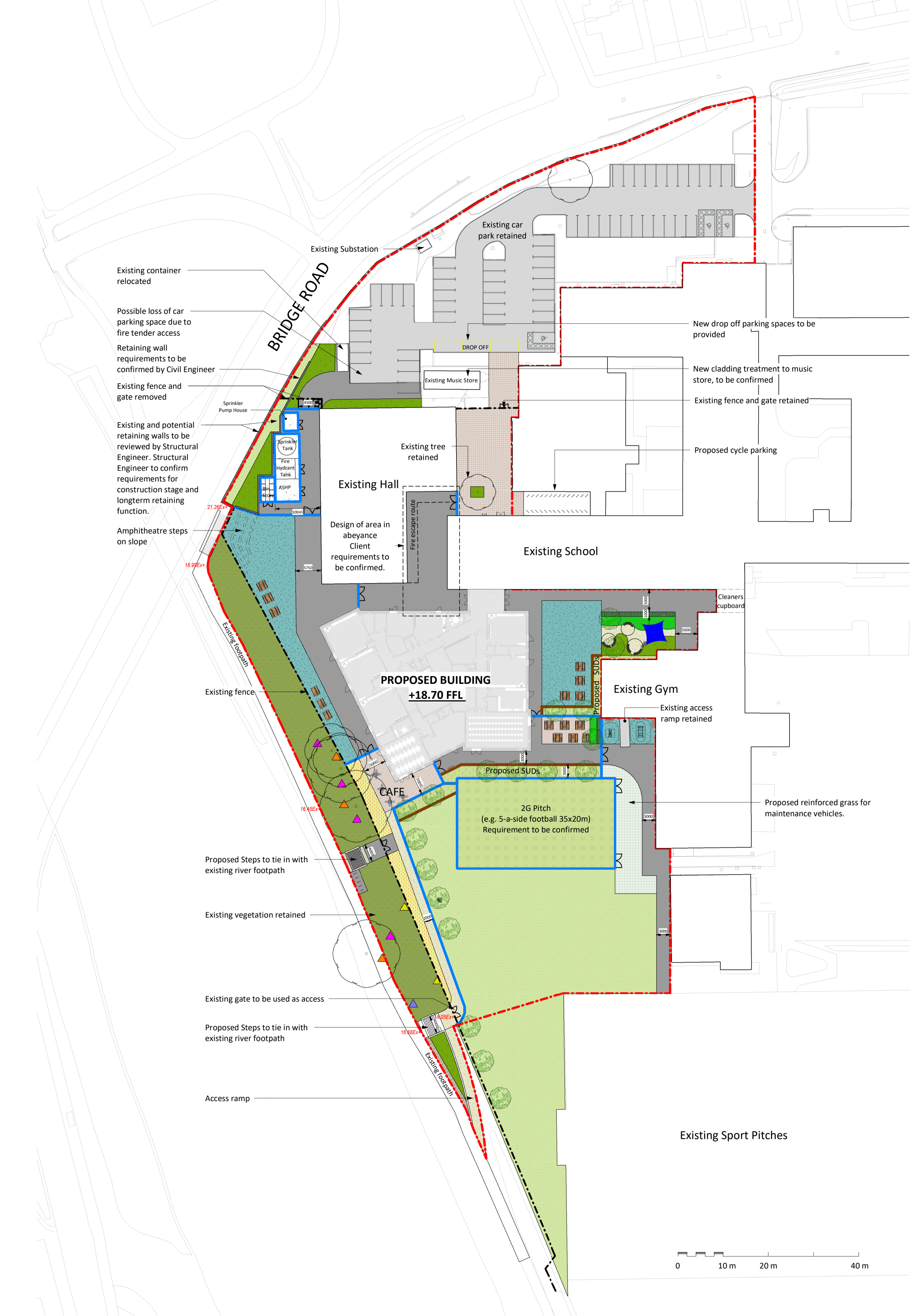

STATUS	REV	DATE	DESCRIPTION	REVISOR
S4	P36	01/11/23	Update to PAC	CMS
S4	P32	28/09/23	Updates to landscape design following client meeting/feedback	CS
S4	P29	22/09/23	STAGE 3 ISSUE	
S0	P27	21/09/23	Draft for tracking coordination	
S0	P101	24/08/23	First Draft for Team Co-ordination	

CLIENT: AECOM  
ORIGINATOR NO: 155452

**CONSULTANT**  
**STRIDE TREGLOWN**  
www.stridetreglown.com © Stride Treglown Limited 2020  
PROJECT: Ysgol Glantaf SRB  
Bridge Road, Cardiff CF14 2JL

DRAWING TITLE  
**Landscape GA Plan**

STATUS CODE	SCALE
S4 : Suitable for stage approval	1 : 500@A1
DRAWING USAGE:	
PROJECT - ORIGINATOR - VOLUME - LEVEL - TYPE - ROLE - CLASS - NUMBER	STATUS - REVISION
GSRB-STL-XX-XX-DR-L-09001	S4_P36