

**© COPYRIGHT**  
 The copyright in this drawing is vested in Sheppard Robson and no license or assignment of any kind has been, or is, granted to any third party whether by provision of copies or originals or otherwise unless agreed in writing.

**DO NOT SCALE FROM THIS DRAWING**  
 The contractor shall check and verify all dimensions on site and report any discrepancies in writing to Sheppard Robson before proceeding with work.

**FOR ELECTRONIC DATA ISSUE**  
 Electronic Data / drawings are issued as "read only" and should not be interrogated for measurement. All dimensions and levels should read, only from those values stated in text on the drawing.

**Note:**  
 For high-level window and louvre types, please refer to drawings:  
 BR0201-SRA-01-ZZ-SH-A-31900  
 BR0101-SRA-ZZ-ZZ-DR-A-31100

Colours shown are indicative and may change.



**East Elevation 2**  
 1 : 100



**South Elevation 2**  
 1 : 100



**North Elevation 2**  
 1 : 100



**West Elevation 2**  
 1 : 100

REV.	DATE	AMENDMENT
P01	04/10/2023	Issued for PAC

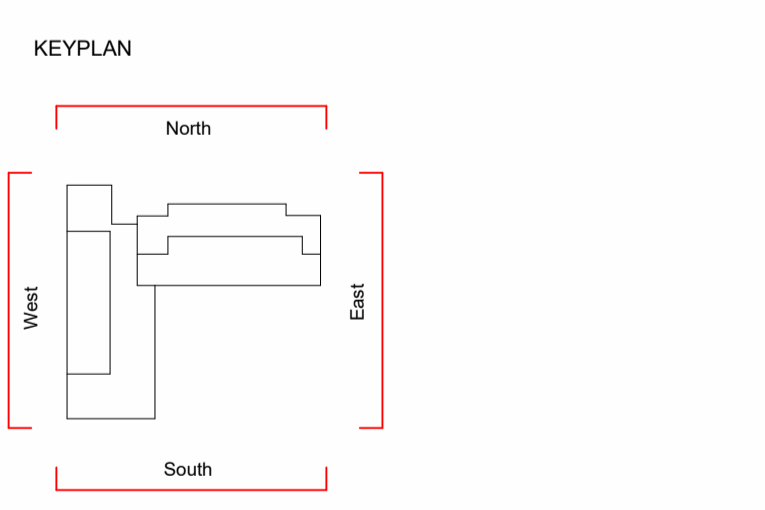

CLIENT  
 Bridgend County Borough Council  
 (Welsh Educational Partnership Company)



SHEPPARD ROBSON

77 Parkway Camden Town London NW11 7PU  
 T: +44 (0)20 7504 1700 E: enquiries@sheppardrobson.com

PROJECT  
 English Medium School (Marlas Site)

SCALE: SRA0 DATE: 04/10/2023 ORIGINATOR: JM CHECKED: RLS AUTHORISED: LB

02 Planning  
 Proposal Long Elevations

STATUS	PURPOSE FOR ISSUE	SR. NO.
S2	For Planning	6840
DRAWING NO.	REV.	
BR0301 - SRA- 01 - ZZ- DR - A - 02200	P01	