

© COPYRIGHT  
The copyright in this drawing is vested in Sheppard Robson and no license or assignment of any kind has been, or is, granted to any third party whether by provision of copies or originals or otherwise unless agreed in writing.

**DO NOT SCALE FROM THIS DRAWING**  
The contractor shall check and verify all dimensions on site and report any discrepancies in writing to Sheppard Robson before proceeding work

**FOR ELECTRONIC DATA ISSUE**  
Electronic Data / drawings are issued as "read only" and should not be interrogated for measurement. All dimensions and levels should read, only from those values stated in text on the drawing.

**KEY**  
Welsh Medium School Site Boundary

REV.	DATE	AMENDMENT
P01	03/10/2023	Issued for PAC
P02	09/10/2023	Issued for PAC

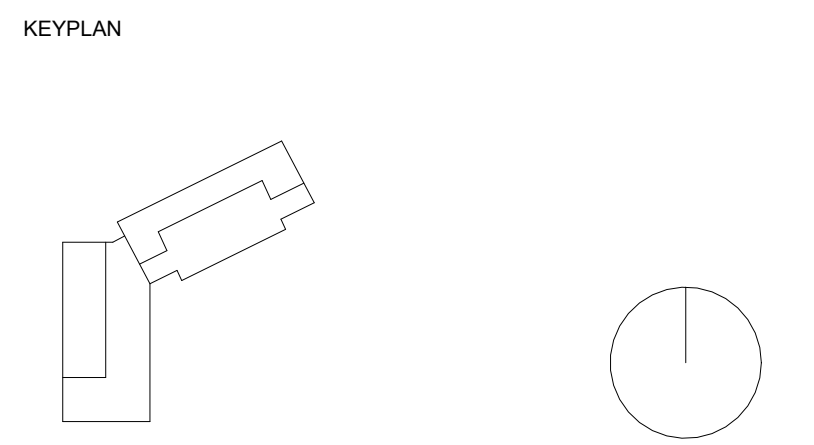

CLIENT  
0 2 4 6 8 10 m

**Bridgend County Borough Council**  
**(Welsh Educational Partnership Company)**



**SHEPPARD ROBSON**

27th Floor City Tower Piccadilly Plaza Manchester M1 4BT  
T: +44 (0)161 233 8900 E: enquiries@sheppardrobson.com

PROJECT  
**Welsh Medium School (Cornell Site)**

SCALE@A1	DATE	ORIGINATOR	CHECKED	AUTHORISED
1 : 200	09/10/2023	JM	RLS	LB

**02 Planning**  
**Proposal Ground Floor Plan**

STATUS PURPOSE FOR ISSUE SR NO.  
**S2 For Planning 6840**

DRAWING NO. REV.  
**BR0201 - SRA - 01 - 00 - DR - A - 02100 P02**



- KEY**
- Primary Entrance
  - Secondary Entrance
  - Circulation
  - Halls and learning Resource
  - Halls and learning resource
  - Infants
  - Juniors
  - Kitchen
  - Nursery
  - Plant
  - Reception
  - Staff and admin
  - Stairs
  - Toilets and changing