



KEY	
	PROPOSED FOUL WATER SEWER
	PROPOSED FOUL WATER MANHOLE
	PROPOSED SURFACE WATER SEWER
	PROPOSED STORAGE TANK
	PROPOSED SURFACE WATER MANHOLE
	PROPOSED FLOW PATH
	PROPOSED PERMEABLE PAVING
	PROPOSED BIORETENTION AREA
	PROPOSED FLOW CONTROL CHAMBER
	PROPOSED RWP
	PROPOSED SURFACE WATER PERFORATED PIPE
	PROPOSED LINEAR DRAINAGE CHANNEL
	EXISTING POROUS PITCH
	EXISTING DCWW EASEMENT ZONE
	ASSUMED DCWW EASEMENT ZONE BASED ON REDUCED LEVELS

- NOTES:
- DRAWING TO BE READ IN CONJUNCTION WITH ALL OTHER RELEVANT PROJECT DRAWINGS AND WITH THE HEALTH AND SAFETY INFORMATION PROVIDED AND/OR WITHIN THE PRE-CONSTRUCTION INFORMATION.
 - USE OF THIS DRAWING DOES NOT ABSOLVE THE CLIENT FROM HIS RESPONSIBILITIES UNDER THE HEALTH AND SAFETY; THE CONSTRUCTION DESIGN AND MANAGEMENT REGULATIONS 2015. THE PRINCIPAL DESIGNER IS REQUIRED TO CONTACT HYDROCK CONSULTANTS PRIOR TO PERMITTING THIS DRAWING TO BE USED IN CONNECTION WITH ANY CONSTRUCTION WORKS.
 - BEFORE COMMENCEMENT OF ANY WORKS ASSOCIATED WITH THE DRAWING REFER TO ALL RELEVANT HEALTH AND SAFETY INFORMATION FOR THE WORKS INCLUDING RESIDUAL RISK INFORMATION.
 - THE CONTRACTOR SHOULD COMPLY WITH HS(G) 47 "AVOIDING DANGER FROM UNDERGROUND SERVICES" WHEN PLANNING, LOCATING AND EXCAVATING AROUND EXISTING SERVICES. IT IS KNOWN THAT EXISTING UTILITY COMPANY UNDERGROUND SERVICES AND APPARATUS ARE PRESENT WITHIN THE PROPOSED WORKS AREA AND IT IS THE CONTRACTORS RESPONSIBILITY TO LOCATE EXISTING SERVICES ON SITE ACCURATELY.
 - INFORMATION REGARDING THE LOCATION AND DEPTH OF EXISTING SERVICES CANNOT BE GUARANTEED BY THE STATUTORY UNDERTAKER.
 - THE CONTRACTOR SHALL CONDUCT THE WORKS WITH DUE REGARD FOR THE ECOLOGICAL AND ENVIRONMENTAL REQUIREMENTS OF THE SCHEME.
 - THIS DRAWING SHALL BE USED FOR THE INTENDED PURPOSE ONLY AND THIS DRAWING HAS BEEN BASED ON INFORMATION PROVIDED BY OTHER PARTIES AND HYDROCK DO NOT WARRANT THE ACCURACY OF THIS INFORMATION. DIMENSIONS SHALL NOT BE SCALED FROM THE DRAWING AND THE CONTRACTOR SHALL BE RESPONSIBLE FOR OBTAINING ALL DIMENSIONS AND LEVELS ON SITE FOR THE ACTUAL SETTING OUT OF THE WORKS. DIMENSIONS MARKED 'DIMENSIONS TO BE SITE CHECKED' ARE SUBJECT TO CONFIRMATION BY THE CONTRACTOR BEFORE THE WORKS COMMENCE.
 - HYDROCK IS NOT RESPONSIBLE FOR CHECKING DIMENSIONS ON SITE.
 - HYDROCK IS NOT RESPONSIBLE FOR SETTING OUT GRID LINES, BUILDING LINE ETC.
 - HYDROCK IS NOT RESPONSIBLE FOR DIMENSIONS USED IN THE ORDERING AND MANUFACTURING OF EQUIPMENT AND THIS SHALL BE THE RESPONSIBILITY OF THE CONTRACTOR.
 - ALL FIGURED LEVELS ARE IN METRES AND RELATED TO EXISTING SURVEY GRID & DATUM UNLESS NOTED OTHERWISE.
 - ALL FIGURED DIMENSIONS ARE IN METRES UNLESS NOTED OTHERWISE.
 - TEMPORARY WORKS DESIGN ASSOCIATED WITH THE CONSTRUCTION OF THE WORKS SHALL BE RESPONSIBILITY OF THE CONTRACTOR.
 - THE CONTRACTOR SHALL MAINTAIN FREE AND OPEN ACCESS TO PUBLIC HIGHWAY AND ADJACENT LANDS AT ALL TIMES DURING THE COURSE OF THE WORKS UNLESS OTHERWISE AGREED IN WRITING WITH THE INTERESTED PARTIES.
 - THE CONTRACTOR SHALL BE RESPONSIBLE FOR THE DESIGN OF ALL TRAFFIC MANAGEMENT PROPOSALS & PHASING. SUCH DETAILS SHALL BE SUBMITTED TO THE LOCAL HIGHWAY AUTHORITY FOR APPROVAL PRIOR TO THE START OF THE WORKS. THE CONTRACTOR SHALL BE RESPONSIBLE FOR ALL ASSOCIATED COSTS AND ORDERS. CONFLICTING INFORMATION SHOWN ON THE ENGINEER'S DRAWINGS OR DISCREPANCIES BETWEEN THE INFORMATION GIVEN BY THE ENGINEER AND THAT PROVIDED BY OTHERS MUST BE REFERRED TO THE ENGINEER BEFORE THE WORKS COMMENCE.

REVISIONS				
P02	PAC Issue	03/10/23	JK	CS CS
P01	First Issue	29/08/23	JK	CS CS
Rev.	Revision Notes	Date	Drawn By	Checked Approved

Hydrock Third Floor, Wharton Place
Cardiff
CF10 1GS
t: +44(0)2920 023665
e: cardiff@hydrock.com

CLIENT
WEPco

PROJECT
BRIDGEND PRIMARY SCHOOLS - MARLAS

TITLE
DRAINAGE STRATEGY

HYDROCK PROJECT NO. C-24390	SCALE @ A1 1:500
---------------------------------------	----------------------------

STATUS DESCRIPTION SUITABLE FOR INFORMATION	STATUS S2
DRAWING NO. BR0301-HYD-XX-XX-DR-C-3000	REVISION P02

PART OF THE MATERIAL IN THIS PLOT HAS BEEN REPRODUCED FROM AN ORDNANCE SURVEY MAP © CROWN COPYRIGHT 2021. ALL RIGHT RESERVED. LICENCE NUMBER 100022432.

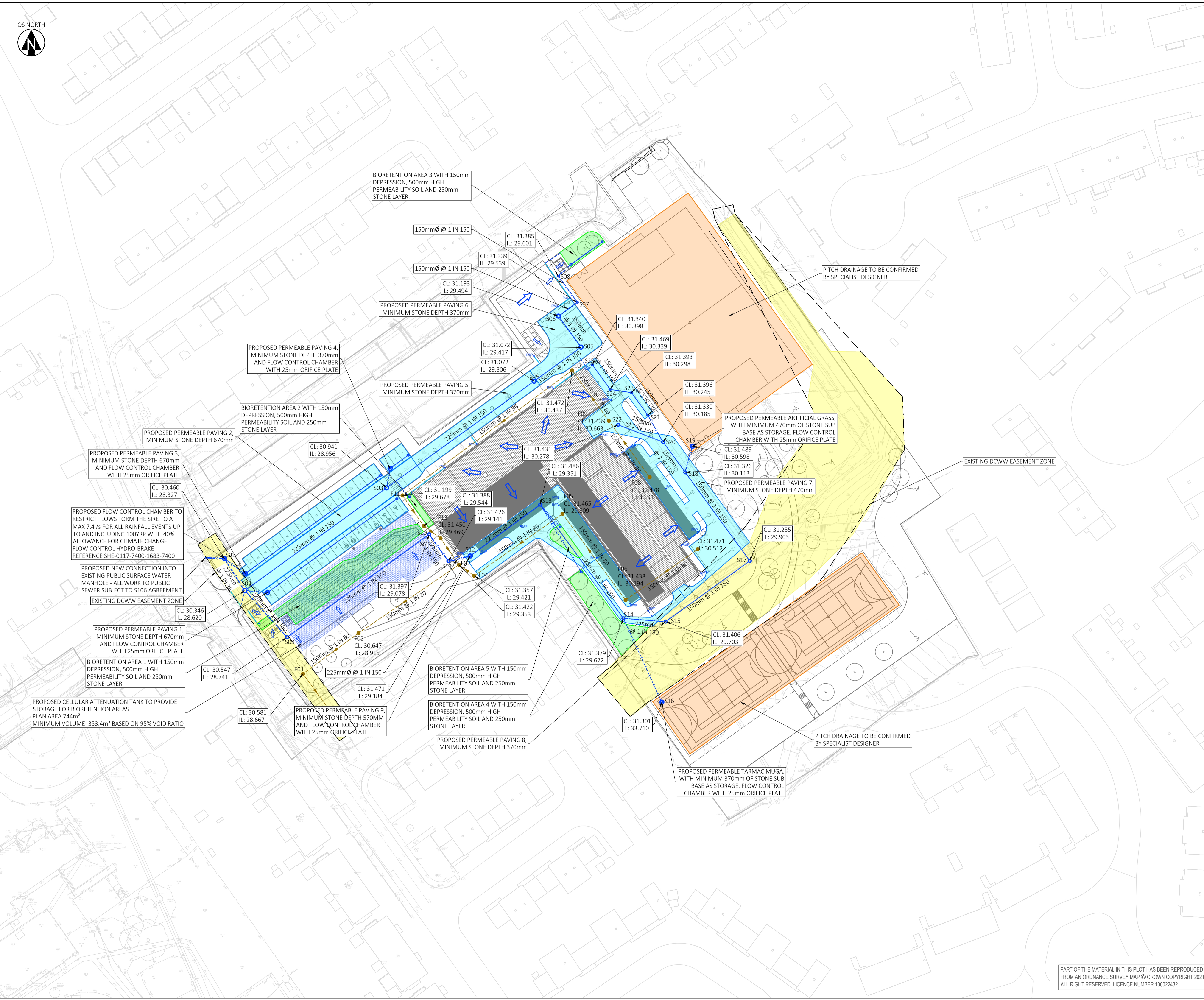

Filename: F:\01_Contracts\2000DC-24390-WEPco_Bridgend Primary\01_WEPco_Drainage\BR0301-HYD-XX-XX-DR-C-3000-Drainage Strategy_Marlas.dwg