

**Access and Circulation
Drop Off/ Pick Up**

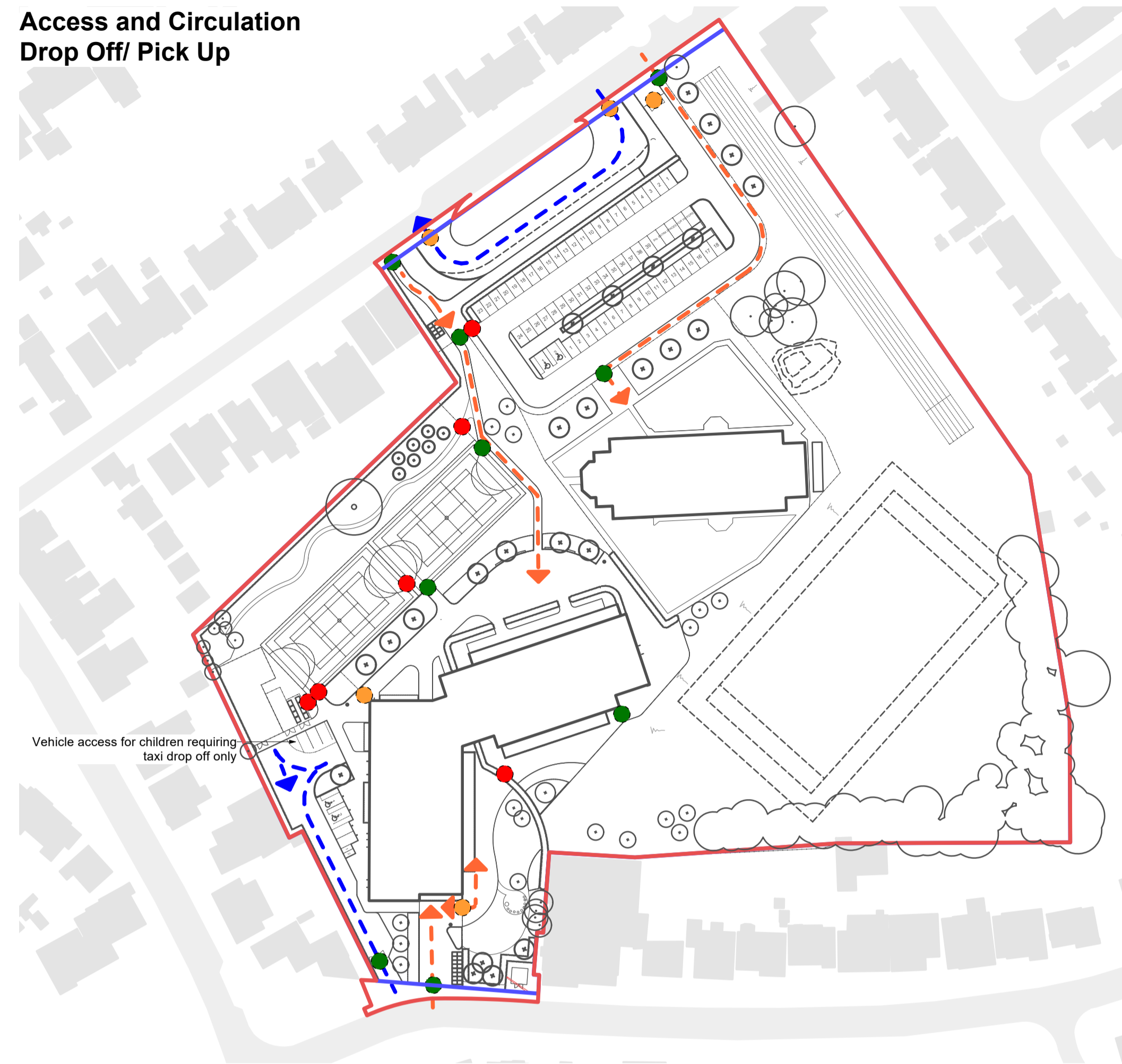

**Access and Circulation
During School Hours**

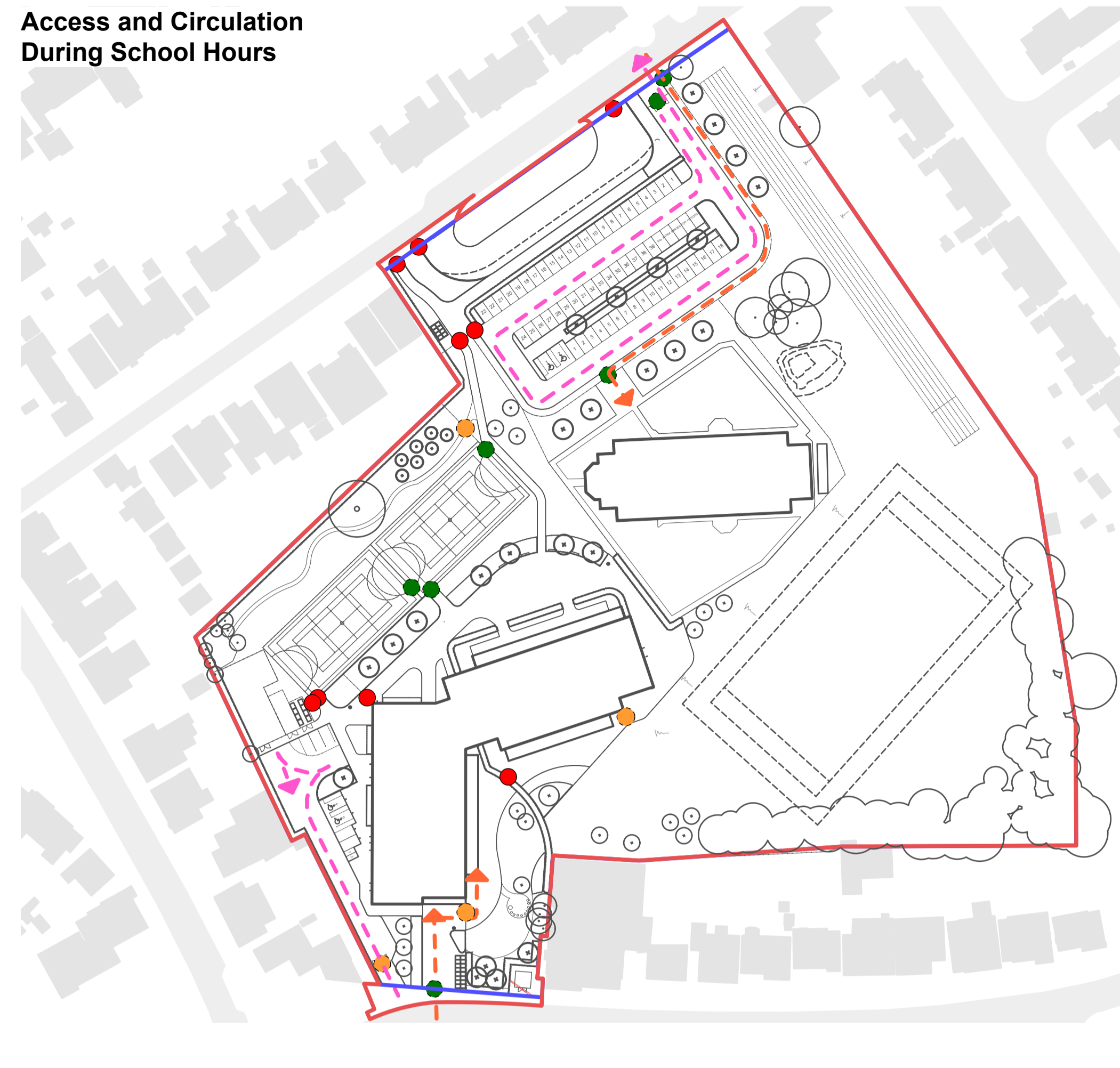

**Services and Maintenance
**To be managed before and after:
drop off and pick up hours**

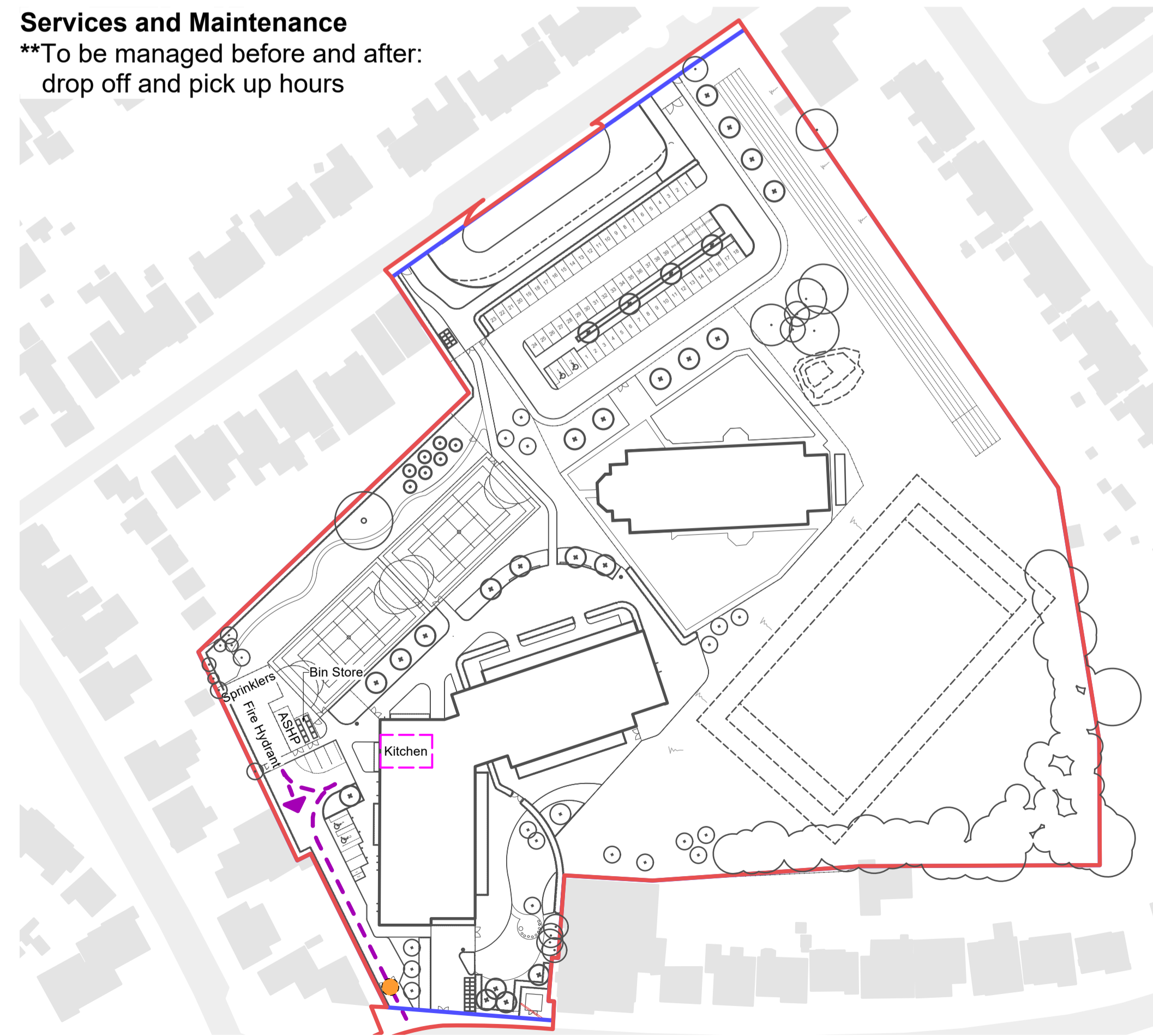

Community Use - Out of Hours

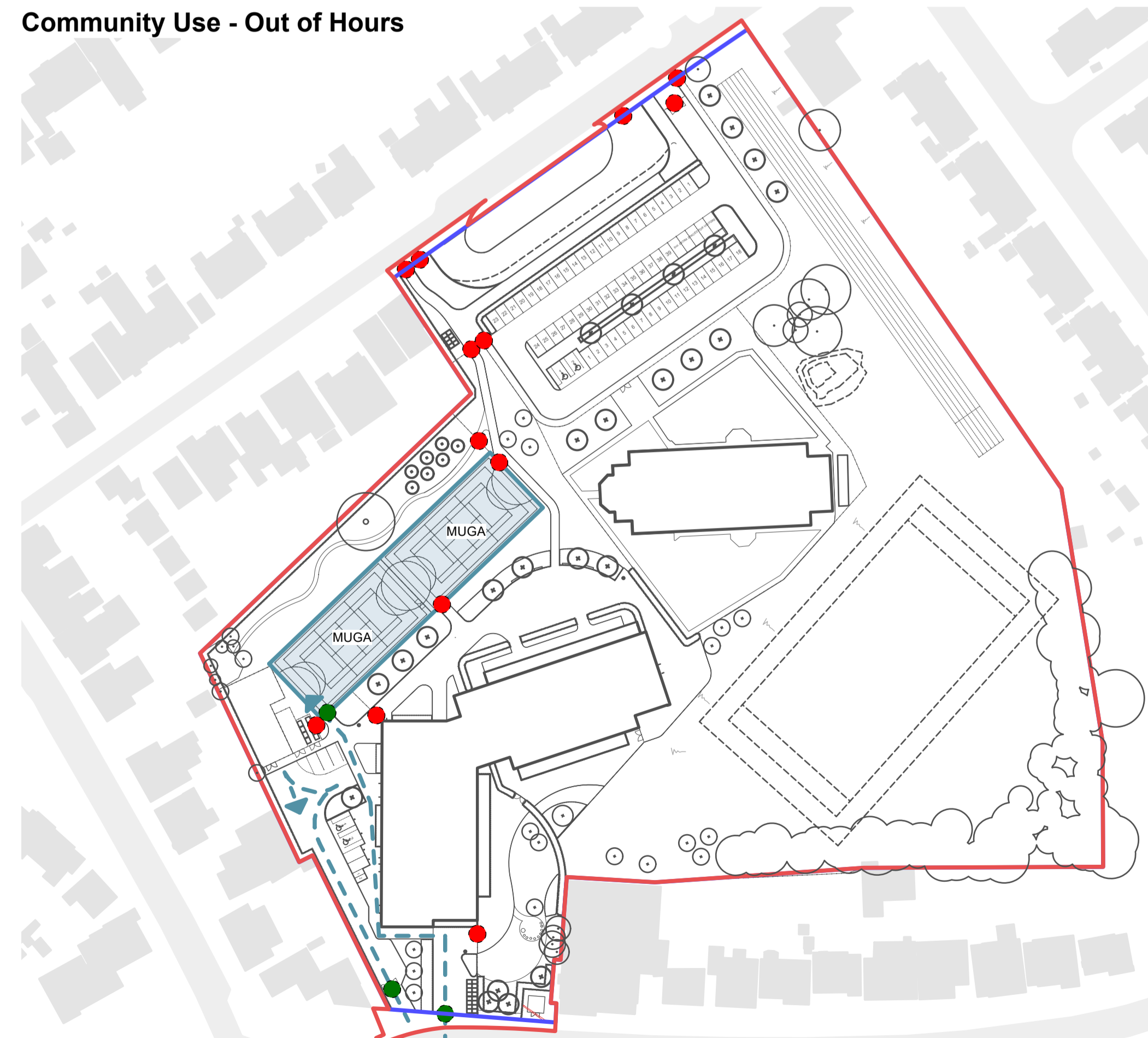

Note
1. Do not scale from this drawing
2. To be read in conjunction with Project Risk Register REF: XXX
3. To be read in conjunction with all other Landscape Architect's drawings

KEY

Gates

- Gate - OPEN
- Gate - MANAGED
- Gate - LOCKED

Movement

- - - Pedestrian Access
- - - Vehicle Access
- - - Drop off: Coach or Taxi Access Only
- - - Service vehicle Access
- - - Out of hours Access

ID	RISK	MITIGATION	DATE MITIGATED
RESIDUAL PROJECT RISKS			

DATE	REV	DESCRIPTION OF REVISION	DRAWN BY	APPROVED BY
27/09/2022	P01	Issued for PAC	KP	LS
REVISIONS				

STATUS
S3 - FOR PLANNING

ares
LANDSCAPE ARCHITECTS

Ares Landscape Architects LTD
Gatecrasher,
51 Eyre Lane
Sheffield
S1 4RB
t: 0114 276 2000
e: hello@aresdesign.co.uk
w: ares.eu.com

CLIENT:
Sheppard Robson

PROJECT TITLE:
Bridgend Primary Schools - Corneli Site

DRAWING TITLE:
Access and Circulation

DRAWING SCALE: 1:1000	DRAWN BY: KP	DRAWN DATE: 27/07/2022
PAPER SIZE: A1	APPROVED BY: LS	ALA PROJECT CODE: ALAT35

DRAWING NUMBER: **BR0201-ALA-00-ZZ-DR-L-20005** STATUS: **S3** REVISION: **P01**