



C Proposed North Elevation C
1 : 100



D Proposed South Elevation D
1 : 100

MATERIAL SCHEDULE	
1	Slate Cladding - Nordic Dark
2	Facing Brickwork - Colour TBC
3	PPC Aluminium Door - Dark Grey
4	PPC Aluminium Curtain Walling - Dark Grey
5	Bi-Parting PPC Aluminium Doors
6	PPC Aluminium Louvres - Dark Grey (RAL TBC)
7	PPC Aluminium Flashing - Dark Grey (RAL TBC)
8	PPC Aluminium Parapet Capping - Dark Grey (RAL TBC)
9	PPC Aluminium Rainwater Goods - Dark Grey (RAL TBC)
10	Dark Grey Aluminium Built Up Cladding - Dark Grey (RAL TBC) - Euroclad Vieo
11	Dark Grey Aluminium Built Up Cladding - Dark Grey (RAL TBC) - Euroclad Opus
12	Metal Roller Shutter Door

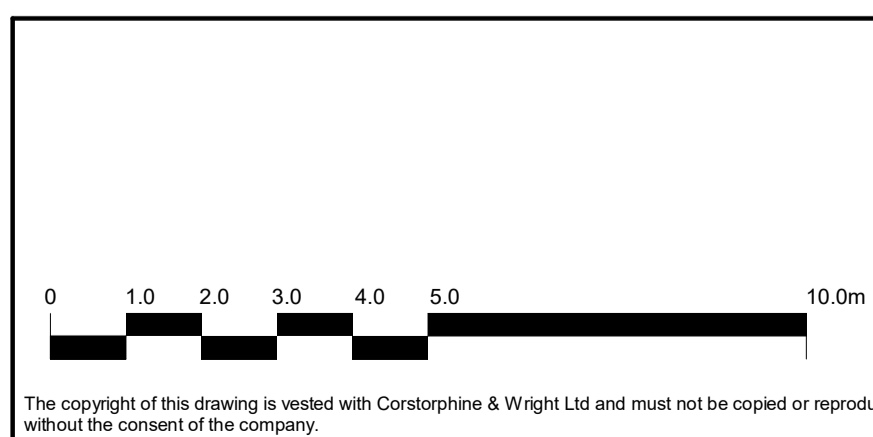

P-02 Issue for pack PAC
P-01 First issue
Rev. Description

18.08.2023 is EHC
02.05.2023 SS EHC
Date Draw. Chk.

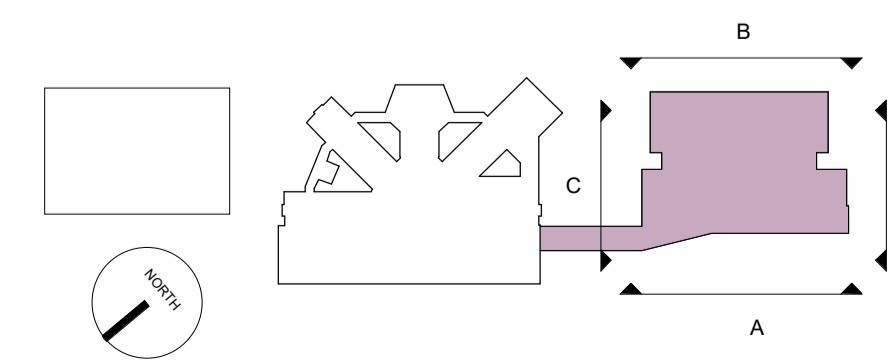

Client: Willmott Dixon Construction Ltd.
Project: Gwent Police Operational Facility
Drawing Title: Training - Proposed Elevation - Sheet 2
Drawing Status: WIP

Corstorphine & Wright

Warwick Studio
Brook Hall, Brook Street, Warwick, CV34 4BL
01926 652 444
corstorphine-wright.com

Drawing No. GPOF-CWA-02-XX-DR-A-0356	Revision P-02
Drawn SS	Checked EHC
Paper Size A1	Scale 1 : 100
Date 17/04/23	